

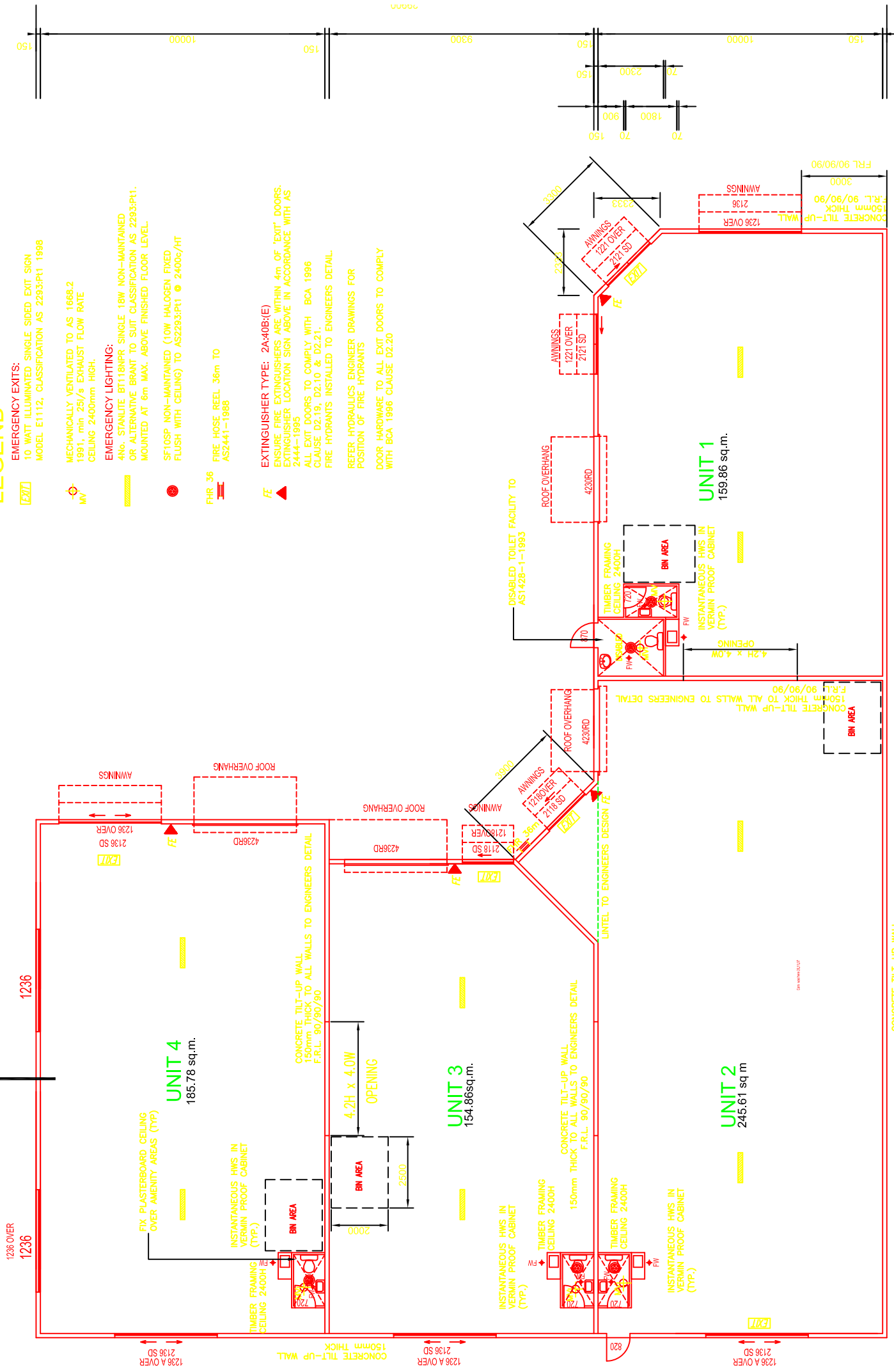

LEGEND

- EMERGENCY EXITS: TO WATT ILLUMINATED SINGLE SIDED EXIT SIGN MODEL E1112, CLASSIFICATION AS 2293P1 1998
- MECHANICALLY VENTILATED TO AS 1668.2 1991, min 25/s EXHAUST FLOW RATE CEILING 2400mm High.
- EMERGENCY LIGHTING: 4No. STANLITE BT118NPR SINGLE, 18W NON-MAINTAINED OR ALTERNATIVE BRANT TO SUIT CLASSIFICATION AS 2293P11. MOUNTED AT 6m MAX. ABOVE FINISHED FLOOR LEVEL.
- SFT05P NON-MAINTAINED (10W HALOGEN FIXED FLUSH WITH CEILING) TO AS2293P11 @ 2400c/HT
- FIRE HOSE REEL 36m TO AS2441-1988
- EXTINGUISHER TYPE: 2A-40B(E) ENSURE FIRE EXTINGUISHERS ARE WITHIN 4m OF 'EXIT' DOORS. EXTINGUISHER LOCATION SIGN ABOVE IN ACCORDANCE WITH AS 2444-1995 ALL EXIT DOORS TO COMPLY WITH BCA 1996 CLAUSE D2.19, D2.10 & D2.21. FIRE HYDRANTS INSTALLED TO ENGINEERS DETAIL. REFER HYDRAULICS ENGINEER DRAWINGS FOR POSITION OF FIRE HYDRANTS DOOR HARDWARE TO ALL EXIT DOORS TO COMPLY WITH BCA 1996 CLAUSE D2.20



CONCRETE TILT-UP WALL
150mm THICK TO ALL WALLS TO ENGINEERS DETAIL
F.R.L. 90/90/90

CONCRETE TILT-UP WALL
150mm THICK
F.R.L. 90/90/90

CONCRETE TILT-UP WALL
150mm THICK
F.R.L. 90/90/90

CONCRETE TILT-UP WALL
150mm THICK TO ALL WALLS TO ENGINEERS DETAIL
F.R.L. 90/90/90

CONCRETE TILT-UP WALL
150mm THICK TO ALL WALLS TO ENGINEERS DETAIL
F.R.L. 90/90/90

CONCRETE TILT-UP WALL
150mm THICK TO ALL WALLS TO ENGINEERS DETAIL
F.R.L. 90/90/90

CONCRETE TILT-UP WALL
150mm THICK TO ALL WALLS TO ENGINEERS DETAIL
F.R.L. 90/90/90

CONCRETE TILT-UP WALL
150mm THICK TO ALL WALLS TO ENGINEERS DETAIL
F.R.L. 90/90/90

CONCRETE TILT-UP WALL
150mm THICK TO ALL WALLS TO ENGINEERS DETAIL
F.R.L. 90/90/90

CONCRETE TILT-UP WALL
150mm THICK TO ALL WALLS TO ENGINEERS DETAIL
F.R.L. 90/90/90

CONCRETE TILT-UP WALL
150mm THICK TO ALL WALLS TO ENGINEERS DETAIL
F.R.L. 90/90/90